



# Community Led Designs for Specialized Housing in the North Co-Creation Workshop #3

In the morning of Day 1, co-creation team members were invited to participate in an open house to explore the four housing designs and engage with the architect teams. Architects from each co-creation team displayed their current progress- including floor plans, visual images of the proposed layouts, and information on materials- their process and next steps. The open house provided a way for co-creation team members to learn about each of the designs, ask questions, and share ideas.

A cartoon-style illustration of a small, single-story house. The house has a bright yellow body and a dark red roof. A small chimney with an orange interior is on the right side of the roof. The front door is dark red with a white handle and a small white keyhole. There are two windows: one above the door and one to the right. Both windows have white frames and are divided into six panes. The house is set on a small patch of brown ground with a few green leaves.

In the afternoon, co-creation team members worked with each other, architects, NAN and TDL team members to review their team's current design and explore final considerations for the schematic design phase including spatial arrangements, use of space, look and feel, and materiality. Several types of activities took place during the afternoon sessions: open discussions guided by questions from architects to probe deeper into various design elements; a spatial arrangement activity using a floor plan and printed room pieces to share ideas and learn about preferred house layouts; exploring how the house might interact with an existing community by placing scaled houses



of the design on a printed aerial map; learning about the role of windows and preferred placements; as well as other activities.

Day 2 began with a morning workshop to provide a final opportunity to review the current design, reflect on learnings from the previous day and outline next steps in the design process. In the afternoon co-creation team members, architects, NAN and TDL joined together in table discussions to share reflections on the co-creation process and the need for change in the housing system.

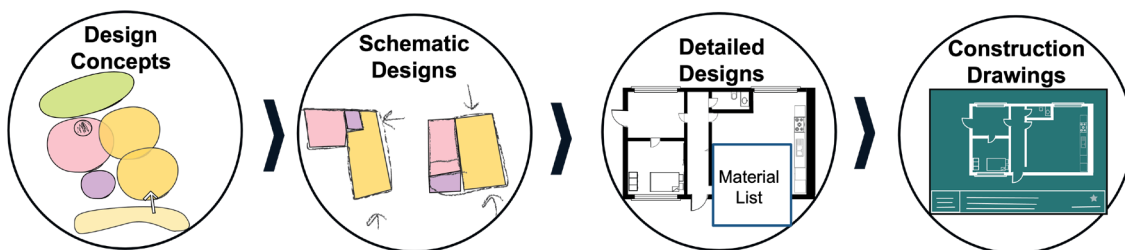

### What comes next?

After reviewing what was heard at Co-Creation Workshop #3, architects began drafting final schematic designs for their team's building type. As the designs move through the stages of detailed design and construction drawings, co-creation team participants will be kept informed about the project's progress. At the final stage of the project, anticipated to be in 2025, when the designs are finalized and ready for implementation NAN will share the final outcomes with co-creation team members. We thank all co-creation team members for their time, knowledge, and generous sharing that has made this project of designing houses by and for NAN members possible.

### Contact Us

#### Michael McKay

Infrastructure & Housing Director  
Nishnawbe Aski Nation  
mmckay@nan.ca | (807) 623-8228

#### Shelagh McCartney

Project Manager, Together Design Lab  
at Toronto Metropolitan University  
hello@togetherdesignlab.com | (416) 979-5000 ext. 2133

Information can also be found on the NAN Housing Strategy webpage: <https://www.nan.ca/resources/nan-housing-strategy/>